

2008 EMBRAER LEGACY 600

SERIAL NUMBER: 1451064



(HQ) Raleigh +1 919-941-8400 info@jetcraft.com www.jetcraft.com

Basel, CH ----- +41 58 158 4958 Hong Kong ----- +852 2178 1638 Moscow, Russia --- +7 495 648 28 69 Teterboro, NJ ---- +1 201 288 1800
Dubai, UAE ----- +971 4 324 3327 Mpls, MN ----- +1 612 238 3870 St. Louis, MO ----- +1 314 409 4791

JETCRAFT

2008 EMBRAER LEGACY 600 SERIAL NUMBER: 1451064

AIRFRAME

1,175 Hours / 475 Cycles As of April 17, 2012
Warranty Start Date - September 2008
C of A Date - September 14, 2008
FAR 91 Certified
Fresh 48 Month Inspection and More - Constant Aviation (April 2012)

ENGINES

	Left	Right
Description	Rolls Royce AE 3007A1E	Rolls Royce AE 3007A1E
Serial #	AE-313110	AE-313111
Total Time Since New	1,175 Hours	1,175 Hours
Total Cycles Since New	475 Cycles	475 Cycles

APU

Description	Sundstrand APS500R with Silencer
Serial Number	SP-E0828011
Total Time	1,360 Hours

AVIONICS

- Honeywell Primus 1000 5-Tube EFIS
- Integrated Standby Instrument System (ISIS)
- Engine Indication and Crew Alerting System (EICAS)
- Dual Integrated Avionics Computers
- Dual VHF Nav System with NAV/ADF/DME
- Dual VHF Communication System with 8.33KHz spacing and Mode S Diversity
- Honeywell CAT II Autopilot/ Flight Director
- Passenger Address and Cabin Interphone System
- Dual Radio Management Units
- Dual FMS / GPS Units
- Airborne Audio System
- Honeywell SSCVR
- Honeywell SSFDR
- Aural Warning Unit
- Dual Digital Clocks
- Dual RVSM Air Data Computers
- Dual Inertial Reference System
- Radio Altimeter
- Artex ELT (406 MHz)
- Honeywell TCAS 2000 with Change 7
- Mk VII EGPWS
- SELCAL
- Dual Stall Protections System
- Single HF Radio
- Central Maintenance Computer

AVIONICS OPTIONS

- 2nd HF Radio
- Communications Management Unit with 3rd Honeywell HF (8.33 kHz Spacing)
- 2nd Radio Altimeter
- Steep Approach Capability
- Two Class II EFB Installed in Cockpit
- Iridium ST-3100 and AeroCom 1000
- Lightning Sensor System
- Auxiliary Flight Data Acquisition Unit

ADDITIONAL EQUIPMENT

- Long Range Fuel System
- Provisions for Extended Over Water OPS
- Cockpit Jumpseat
- Secure Cockpit Door
- Forward Crew Lavatory
- Flight Attendant Seat
- Additional VIP Control in Aft Cabin Zone at LH Aft-Facing Seat
- Additional 77 Cubic Feet Oxygen Bottle
- Twelve (12) Man Life Raft
- Six (6) Man Life Raft
- Dual DVD System
- Dual 17" Cabin Monitors Forward Bulkhead
- 17" Monitor on Aft Bulkhead
- Airshow 410
- Thirteen (13) 115V AC Outlets Throughout
- Microwave and Flight Oven
- Nespresso Coffemaker

EXTERIOR

Overall Matterhorn White Wings and Fuselage with Dark Gray, Blue Gray and Pale Blue Accent Striping

INTERIOR

Seating for Thirteen (13) Passengers in an Executive Three (3) Zone Configuration Featuring:

- Four (4) Place Forward Club with Forward Cabin Pocket Door
- Mid Cabin Four (4) Place Conference/Dining Area with Hi/Low Table on L/H Side & a Credenza on R/H Side with Mid Cabin Removable Bulkhead and Privacy Curtain
- Aft Cabin Three (3) Place Divan on the Aft R/H Side and Two (2) Facing Single Seats on the Left
- Fully Equipped Forward Galley and Crew Lavatory
- Aft Lavatory with Vanity and Walk-In Baggage Compartment
- Antique Nickel Plating, with Taupe Carpets, Wicker-Colored Leather Seats
- Cabinetry Finished in Striking Satin-Colored Birdseye Maple

CONTINUED

Specifications and/or descriptions are provided as introductory information only and do not constitute representations or warranties. Verification of specifications remain the sole responsibility of purchaser. Aircraft is subject to prior sale, lease, and/or removal from the market without prior notice.

(HQ) Raleigh +1 919-941-8400 info@jetcraft.com www.jetcraft.com

Basel, CH ----- +41 58 158 4958 | Hong Kong ----- +852 2178 1638 | Moscow, Russia --- +7 495 648 28 69 | Teterboro, NJ ---- +1 201 288 1800
Dubai, UAE ----- +971 4 324 3327 | Mpls, MN ----- +1 612 238 3870 | St. Louis, MO ----- +1 314 409 4791

JETCRAFT

2008 EMBRAER LEGACY 600 SERIAL NUMBER: 1451064

MAINTENANCE

<u>Inspection</u>	<u>Last Complied With</u>	<u>Next Due</u>
L4 T48 (48 mo)	April 2012	2016

WARRANTY

From the factory delivery date, Legacy 600 warranty period is as follows:

- | | |
|---|---|
| • Parts manufactured by Embraer or its subcontractors (including structural parts): | 60 Month or 5,000 FH, whichever occurs first |
| • Parts manufactured by Embraer's vendors: | 36 Month |
| • Avionics and avionics accessories - Covered directly by Honeywell: | 60 Month or 5,000 FH, whichever occurs first |
| • APU and APU accessories - Covered directly by Hamilton Sundstrand: | 60 Month or 3,000 FH, or 6,000 FC, whichever occurs first |
| • Engines and engines accessories - covered directly by Rolls Royce: | 60 Month or 2,500 FH, whichever occurs first |

Cabin Layout

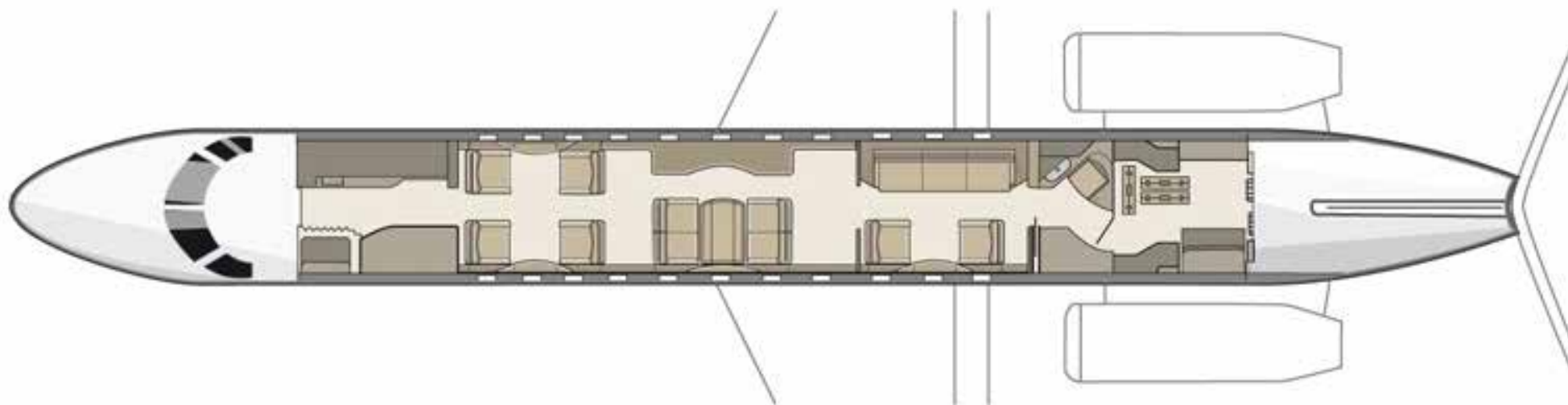

Specifications and/or descriptions are provided as introductory information only and do not constitute representations or warranties. Verification of specifications remain the sole responsibility of purchaser. Aircraft is subject to prior sale, lease, and/or removal from the market without prior notice.

(HQ) Raleigh +1 919-941-8400 info@jetcraft.com www.jetcraft.com

Basel, CH ----- +41 58 158 4958 | Hong Kong ----- +852 2178 1638 | Moscow, Russia --- +7 495 648 28 69 | Teterboro, NJ ---- +1 201 288 1800
Dubai, UAE ----- +971 4 324 3327 | Mpls, MN ----- +1 612 238 3870 | St. Louis, MO ----- +1 314 409 4791

JETCRAFT

2008 EMBRAER LEGACY 600 SERIAL NUMBER: 1451064

Forward Cabin



Specifications and/or descriptions are provided as introductory information only and do not constitute representations or warranties. Verification of specifications remain the sole responsibility of purchaser. Aircraft is subject to prior sale, lease, and/or removal from the market without prior notice.

(HQ) Raleigh +1 919-941-8400 info@jetcraft.com www.jetcraft.com

Basel, CH ----- +41 58 158 4958 | Hong Kong ----- +852 2178 1638 | Moscow, Russia --- +7 495 648 28 69 | Teterboro, NJ ---- +1 201 288 1800
Dubai, UAE ----- +971 4 324 3327 | Mpls, MN ----- +1 612 238 3870 | St. Louis, MO ----- +1 314 409 4791

JETCRAFT

2008 EMBRAER LEGACY 600 SERIAL NUMBER: 1451064

Aft Cabin Facing Forward



Specifications and/or descriptions are provided as introductory information only and do not constitute representations or warranties. Verification of specifications remain the sole responsibility of purchaser. Aircraft is subject to prior sale, lease, and/or removal from the market without prior notice.

(HQ) Raleigh +1 919-941-8400 info@jetcraft.com www.jetcraft.com

Basel, CH ----- +41 58 158 4958 | Hong Kong ----- +852 2178 1638 | Moscow, Russia --- +7 495 648 28 69 | Teterboro, NJ ---- +1 201 288 1800
Dubai, UAE ----- +971 4 324 3327 | Mpls, MN ----- +1 612 238 3870 | St. Louis, MO ----- +1 314 409 4791

JETCRAFT

2008 EMBRAER LEGACY 600 SERIAL NUMBER: 1451064

Mid Cabin



Specifications and/or descriptions are provided as introductory information only and do not constitute representations or warranties. Verification of specifications remain the sole responsibility of purchaser. Aircraft is subject to prior sale, lease, and/or removal from the market without prior notice.

(HQ) Raleigh +1 919-941-8400 info@jetcraft.com www.jetcraft.com

Basel, CH ----- +41 58 158 4958 | Hong Kong ----- +852 2178 1638 | Moscow, Russia --- +7 495 648 28 69 | Teterboro, NJ ---- +1 201 288 1800
Dubai, UAE ----- +971 4 324 3327 | Mpls, MN ----- +1 612 238 3870 | St. Louis, MO ----- +1 314 409 4791

JETCRAFT

2008 EMBRAER LEGACY 600 SERIAL NUMBER: 1451064

Club Seating



Specifications and/or descriptions are provided as introductory information only and do not constitute representations or warranties. Verification of specifications remain the sole responsibility of purchaser. Aircraft is subject to prior sale, lease, and/or removal from the market without prior notice.

(HQ) Raleigh +1 919-941-8400 | info@jetcraft.com | www.jetcraft.com

Basel, CH ----- +41 58 158 4958 | Hong Kong ----- +852 2178 1638 | Moscow, Russia --- +7 495 648 28 69 | Teterboro, NJ ---- +1 201 288 1800
Dubai, UAE ----- +971 4 324 3327 | Mpls, MN ----- +1 612 238 3870 | St. Louis, MO ----- +1 314 409 4791

JETCRAFT

2008 EMBRAER LEGACY 600 SERIAL NUMBER: 1451064

Forward Galley



Galley Microwave & Warmer



Specifications and/or descriptions are provided as introductory information only and do not constitute representations or warranties. Verification of specifications remain the sole responsibility of purchaser. Aircraft is subject to prior sale, lease, and/or removal from the market without prior notice.

(HQ) Raleigh +1 919-941-8400 info@jetcraft.com www.jetcraft.com

Basel, CH ----- +41 58 158 4958 | Hong Kong ----- +852 2178 1638 | Moscow, Russia --- +7 495 648 28 69 | Teterboro, NJ ---- +1 201 288 1800
Dubai, UAE ----- +971 4 324 3327 | Mpls, MN ----- +1 612 238 3870 | St. Louis, MO ----- +1 314 409 4791

JETCRAFT

2008 EMBRAER LEGACY 600 SERIAL NUMBER: 1451064

Forward Galley (Open)



Additional Storage (Open)



Side Wall Detail



Specifications and/or descriptions are provided as introductory information only and do not constitute representations or warranties. Verification of specifications remain the sole responsibility of purchaser. Aircraft is subject to prior sale, lease, and/or removal from the market without prior notice.

(HQ) Raleigh +1 919-941-8400 info@jetcraft.com www.jetcraft.com

Basel, CH ----- +41 58 158 4958
Dubai, UAE ----- +971 4 324 3327

Hong Kong ----- +852 2178 1638
Mpls, MN ----- +1 612 238 3870

Moscow, Russia --- +7 495 648 28 69
St. Louis, MO ----- +1 314 409 4791

Teterboro, NJ ----- +1 201 288 1800

JETCRAFT

2008 EMBRAER LEGACY 600 SERIAL NUMBER: 1451064

Lavatory



Entertainment Center



Control Panel Detail



Specifications and/or descriptions are provided as introductory information only and do not constitute representations or warranties. Verification of specifications remain the sole responsibility of purchaser. Aircraft is subject to prior sale, lease, and/or removal from the market without prior notice.

(HQ) Raleigh +1 919-941-8400 info@jetcraft.com www.jetcraft.com

Basel, CH ----- +41 58 158 4958 | Hong Kong ----- +852 2178 1638 | Moscow, Russia --- +7 495 648 28 69 | Teterboro, NJ ----- +1 201 288 1800
Dubai, UAE ----- +971 4 324 3327 | Mpls, MN ----- +1 612 238 3870 | St. Louis, MO ----- +1 314 409 4791

JETCRAFT

2008 EMBRAER LEGACY 600 SERIAL NUMBER: 1451064

Avionics Suite



Specifications and/or descriptions are provided as introductory information only and do not constitute representations or warranties. Verification of specifications remain the sole responsibility of purchaser. Aircraft is subject to prior sale, lease, and/or removal from the market without prior notice.

(HQ) Raleigh +1 919-941-8400 info@jetcraft.com www.jetcraft.com

Basel, CH ----- +41 58 158 4958
Dubai, UAE ----- +971 4 324 3327

Hong Kong ----- +852 2178 1638
Mpls, MN ----- +1 612 238 3870

Moscow, Russia --- +7 495 648 28 69
St. Louis, MO ----- +1 314 409 4791

Teterboro, NJ ---- +1 201 288 1800

JETCRAFT

2008 EMBRAER LEGACY 600 SERIAL NUMBER: 1451064

Exterior Nose Detail



Specifications and/or descriptions are provided as introductory information only and do not constitute representations or warranties. Verification of specifications remain the sole responsibility of purchaser. Aircraft is subject to prior sale, lease, and/or removal from the market without prior notice.

(HQ) Raleigh +1 919-941-8400 info@jetcraft.com www.jetcraft.com

Basel, CH ----- +41 58 158 4958 | Hong Kong ----- +852 2178 1638 | Moscow, Russia --- +7 495 648 28 69 | Teterboro, NJ ---- +1 201 288 1800
Dubai, UAE ----- +971 4 324 3327 | Mpls, MN ----- +1 612 238 3870 | St. Louis, MO ----- +1 314 409 4791

JETCRAFT

2008 EMBRAER LEGACY 600 SERIAL NUMBER: 1451064

Back Detail



Tail Detail



Specifications and/or descriptions are provided as introductory information only and do not constitute representations or warranties. Verification of specifications remain the sole responsibility of purchaser. Aircraft is subject to prior sale, lease, and/or removal from the market without prior notice.

(HQ) Raleigh +1 919-941-8400 info@jetcraft.com www.jetcraft.com

Basel, CH ----- +41 58 158 4958 | Hong Kong ----- +852 2178 1638 | Moscow, Russia --- +7 495 648 28 69 | Teterboro, NJ ---- +1 201 288 1800
Dubai, UAE ----- +971 4 324 3327 | Mpls, MN ----- +1 612 238 3870 | St. Louis, MO ----- +1 314 409 4791

JETCRAFT

2008 EMBRAER LEGACY 600 SERIAL NUMBER: 1451064

Exterior Paint Detail



Specifications and/or descriptions are provided as introductory information only and do not constitute representations or warranties. Verification of specifications remain the sole responsibility of purchaser. Aircraft is subject to prior sale, lease, and/or removal from the market without prior notice.

(HQ) Raleigh +1 919-941-8400 info@jetcraft.com www.jetcraft.com

Basel, CH ----- +41 58 158 4958 | Hong Kong ----- +852 2178 1638 | Moscow, Russia --- +7 495 648 28 69 | Teterboro, NJ ---- +1 201 288 1800
Dubai, UAE ----- +971 4 324 3327 | Mpls, MN ----- +1 612 238 3870 | St. Louis, MO ----- +1 314 409 4791

JETCRAFT

AIRCRAFT ACQUISITIONS, SALES AND TRADES

AIRBUS BOEING BOMBARDIER CESSNA DASSAULT EMBRAER GULFSTREAM HAWKER

Whether you're looking to buy an aircraft or sell one, Jetcraft will put five decades of experience to work making it happen. Flawlessly. Because when you turn to us, you're tapping into an international team of specialists that consistently transform complex challenges into solutions. We build our entire approach around you, leveraging our market expertise and extensive industry partnerships to guarantee you'll always get the best advice — and the best deals. So give us a call. And leave doubt on the tarmac.



(HQ) Raleigh +1 919-941-8400 info@jetcraft.com www.jetcraft.com

Basel, CH ----- +41 58 158 4958 | Hong Kong ----- +852 2178 1638 | Moscow, Russia --- +7 495 648 28 69 | Teterboro, NJ ---- +1 201 288 1800
Dubai, UAE ----- + 971 4 324 3327 | Mpls, MN ----- +1 612 238 3870 | St. Louis, MO ----- +1 314 409 4791

JETCRAFT